

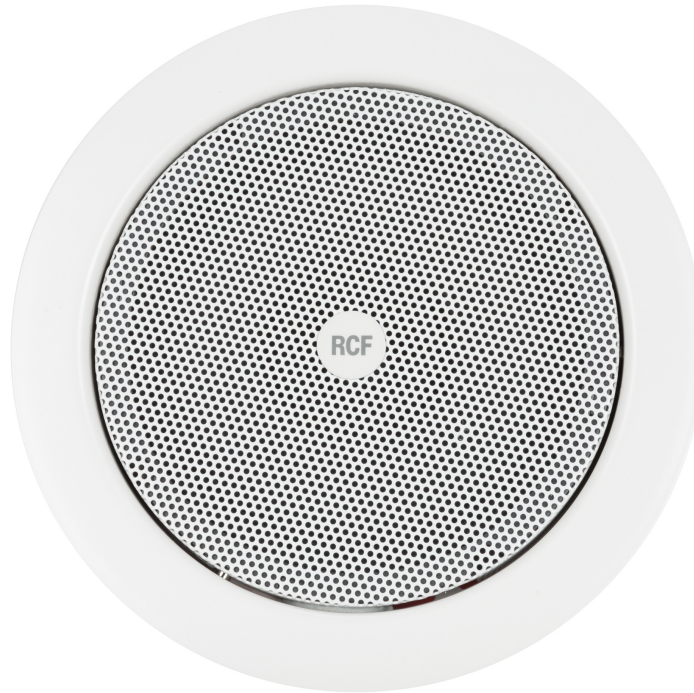

PL 68EN

CEILING SPEAKER WITH FIRE DOME



Description

PL 68EN is a ceiling speaker featuring a flameproof steel back can, designed for recess installation into ceilings or panels. It is especially suitable for broadcasting alarm messages thanks to the highly intelligible sound reproduction and its resistance to high temperatures reached during fires. The terminal connection blocks, for input and output flameproof cables, are made of ceramic material. A thermal fuse protects the integrity of the line in case of heat affecting the speaker. Ground screw available (if needed). Cables inside speaker made using flameproof leads.

Features

- › 6" fullrange transducer.
- › Power selectable (100 V): 6 W - 3 W - 1.5 W.
- › 94 dB sensitivity.
- › Colour white RAL 9003.
- › Steel frame, grille and back can.
- › In/out ceramic terminal block.
- › Thermal fuse protection.

Part Number

13133082 PL 68EN

100 V

White - RAL 9003 EAN 8024530011857



PL 68EN

CEILING SPEAKER WITH FIRE DOME

Line Art 2D

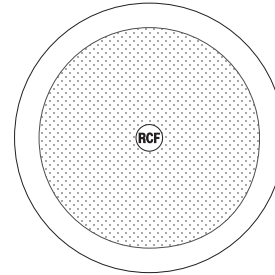
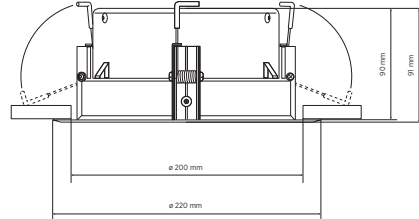

TECHNICAL SPECIFICATIONS

Acoustical specifications

Frequency Response (-10dB)	230 Hz ÷ 20000 Hz
Max SPL @ 1m	102 dB
Max SPL @ 4m	90 dB
Coverage angle	126°
System Sensitivity	94 dB
System Sensitivity 1W @ 4m	82 dB

Power section

Amplification	Full Range
Power Handling	6 W
Peak Power Handling	24 W PEAK
Protections	Thermal fuse
Recommended Amplifiers	DXT 3000, DXT 4000, DXT 7000

Transducers

Fullrange	1 x 6.0"
-----------	----------

Input/Output section

Input connectors	Ceramic screw terminals
Output connectors	Ceramic screw terminals
Constant Voltage Transformer	100 V
Power selection 1	6 W - 1667 ohm
Power selection 2	3 W - 3333 ohm
Power selection 3	1.5 W - 6667 ohm

Standard compliance

Safety agency	CE compliant
EN54-24 certified	Yes
CPR number	1488-CPR-0486/W

Physical specifications

Cabinet/Case Material	Metal
Hardware	Steel back cover
Grille	Steel
Color	White - RAL 9003
Size	
Height	91 mm / 3.58 inches
Recessed Depth	90 mm / 3.54 inches
Diameter	220 mm / 8.66 inches
Cut out diameter	200 mm / 7.87 inches
Weight	1.12 kg / 2.47 lbs