

v1.0

User Manual

English

Reading Guide

Note

△ Important consideration

Recommendation

We recommend that users watch tutorial videos and read the user manual first to understand the usage process.
<https://www.obsbot.com/download>



Tutorial Video

Users can access and watch tutorial videos through the following link and QR code to learn how to use the product correctly.
<https://www.obsbot.com/explore/obsbot-meet-2>



OBSBOT Meet 2 Overview

About Meet 2

OBSBOT Meet 2 is an AI-powered 4K webcam that uses deep learning neural networks computing to achieve powerful Auto-framing features. It's designed to give users exciting new abilities and high-quality video for live streaming, video calls, and conferences.

OBSBOT Meet 2 is connected to the computer via USB, plug and play. It also comes with OBSBOT Center software to expand more advanced functions.

⚠ System Requirements

Windows 10 (64-bit) or later
macOS 11.0 or later

⚠ Recommended for 1080p 60fps and 4K

Recommended Apple computers:

- 1 MacBook Pro (2018, 8th Gen Intel® Core™ i5 Processors or later)
- 2 MacBook Air (2018, 8th Gen Intel® Core™ i5 Processors or later)
- 3 iMac Retina (2019, 8th Gen Intel® Core™ i5 Processors or later)

Recommended PC configuration:

- 1 CPU: 7th Gen Intel® Core™ i5 Processors or later
- 2 RAM: 8GB

Parts Info



01. 4K Ultra HD lens
02. Camera Indicator
03. Dual Microphone

04. USB-C Port
05. UNC 1/4-20 Interface

Setting Up Meet 2

Placement Instructions

1. Placement on a Monitor

Please operate as shown in the figure:

- 1 Open the flexible base, set the magnetic on the monitor.
- 2 Making sure the foot on the flexible base is flush with the back of your monitor.
- 3 Place Meet 2 on the magnetic mount.

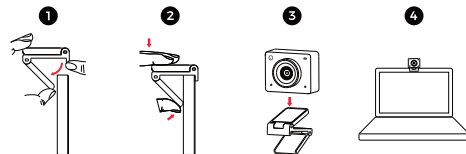

2. Placement on a Tripod

OBSBOT Meet 2 is equipped with a standard UNC 1/4-20 nut connector on the base for mounting the camera to a stand/tripod.

Connect to the Computer

OBSBOT Meet 2 is compatible with both Windows and Mac computers. To set up your OBSBOT Meet 2, use the standard data cable to connect it to the USB port on your laptop or desktop computer. If necessary, use the provided USB-C to USB-A adapter. The webcam will automatically install on your device. Please wait a few seconds for the installation to finish before attempting to access the webcam. After the installation is complete, you can use popular video call platforms such as Zoom, Microsoft Teams, Skype, or Google Meet to start streaming with your Meet 2.



- ① If the product is in working condition for a long time, the bottom of the product will heat up, which is normal situation.
- ② To avoid compatibility problems, be sure to use the standard data cable to connect the computer.
- ③ To prevent the product from malfunctioning due to insufficient power supply, please connect it directly to your computer or use an expansion dock with an independent power supply.
- ④ 4K streaming requires compatible third-party software.

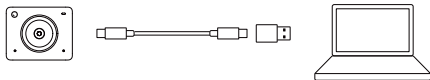

Sleep Mode

① Manual Sleep

You can manually sleep the device through the OBSBOT Center software. If the indicator light is off, it means that the sleep mode is activated.

② Device Auto Sleep

You can use OBSBOT Center software to set the sleep time so that it automatically enters sleep mode as needed.

Zoom

OBSBOT Meet 2 supports 4x digital zoom. The default is 1x. Users can do manual control for zoom settings from 1x to 4x via OBSBOT Center software.

Focus

The OBSBOT Meet 2 supports two focusing methods.

① Auto-Focus

Utilizing OBSBOT's advanced AI technology, the auto-focus feature intelligently adjusts the lens in real time, ensuring that you remain in focus at all times, regardless of your proximity to the camera.

② Manual Focus

Users can disable the auto-focus feature and manually adjust focus when using OBSBOT Center software.

HDR

By default, HDR feature is disabled. However, users have the option to enable HDR on the OBSBOT Center software to enhance their appearance on video, even in low light or direct sunlight.

Auto Framing

OBSBOT Meet 2 supports two types of Auto framing. You can activate the Auto Framing feature on OBSBOT Center software.

① Group mode

Automatically adjust the composition based on the AI algorithm to fit multiple people in the scene.

② Single mode

You can switch to the [Single mode] in the OBSBOT Center software. After switching, the device will automatically select the person closest to compose the picture, and the person will be placed in the center of the screen.

Various Shooting Modes

The OBSBOT Meet 2 offers three shooting modes, with landscape mode being the default.

① Landscape shooting

This mode is suitable for conventional mounted cameras.

② Portrait shooting

Rotating the camera to vertically mount it will automatically enter into the portrait mode.

⚠ The automatic rotation feature can only be used in software that supports it, such as OBS, etc. Some other software may require manual rotation.

③ Up-side-down shooting

The camera can be installed upside down, and the screen will automatically rotate for use.

Indicator Description

Equipment Status	Indicator status
Power-on initialization	Blue light flashes slowly
Standard Mode	Green light keeps on
Auto framing	Purple light keeps on
Firmware upgrading	Blue/yellow flash alternately
Firmware upgrade failed	Red light flashes slowly
Device in fault, such as AI errors, etc.	Red light keeps on
Sleep mode	Light off

OBSBOT Center

Software Overview

OBSBOT Meet 2 provides advanced users of Windows and Mac with a control software for OBSBOT Center, which allows you to perform a series of extended operations on the camera, such as enable or disable auto framing, zoom in or out and so on.

Download and Installation

Download and install OBSBOT Center through <https://www.obsbot.com/download> to further enhance your user experience.

Firmware Upgrade

OBSBOT Meet 2 upgrades through OBSBOT Center software. When firmware is available for update, there will be corresponding prompts after connecting the device. Please follow the info on prompts.

⚠ Do not disconnect the camera during firmware upgrade process.

Please note that the content may be updated without prior notice. To access the most recent version of the manual book, please download it from: <https://www.obsbot.com>